

The uniqueness of this road racing event creates safety issues that you might not automatically think about.

**Here are a few tips to help you enjoy the TT Festival:**

- The TT Course is entirely comprised of public roads, and these roads are closed during racing. However, it is important to remember that when the roads are open, both residents and visitors use these same sections of the course for their day to day activities. Be prepared for regular traffic on the TT Course when the roads are open, including queues at roundabouts and junctions
- You might be tempted to 'open up' your machine on long stretches of road, but for the safety of other road users, please drive well within your capabilities and be mindful of your surroundings – expect the unexpected
- On right-hand bends make sure that both yourself and your machine are behind the centre white line – not just your tyres
- The TT Festival attracts visitors from far and wide, many of whom may not be used to riding on the left hand side of the road. With this in mind, please take extra care when approaching areas where their journey might start, for example campsites
- Any driving ban imposed by an Isle of Man Court is applicable in the UK as there is now a reciprocal ban agreement in place – so a moment of madness could cost you dear in the long term
- Since the 2010 festival works have taken place at Quarterbridge and Signpost Corner in Douglas. Please be mindful of the changes in these areas.
- In addition to watching the racing, you will probably want to enjoy the many attractions on offer around the Island. Naturally you may fancy the odd beer or two, but if you are going to enjoy the local brew then please leave your bike where you are staying. Alternatively stick to a non-alcoholic drink as:

**Riding + Alcohol + Unfamiliar Roads  
= Injury + Misery**

# One-way over the Mountain

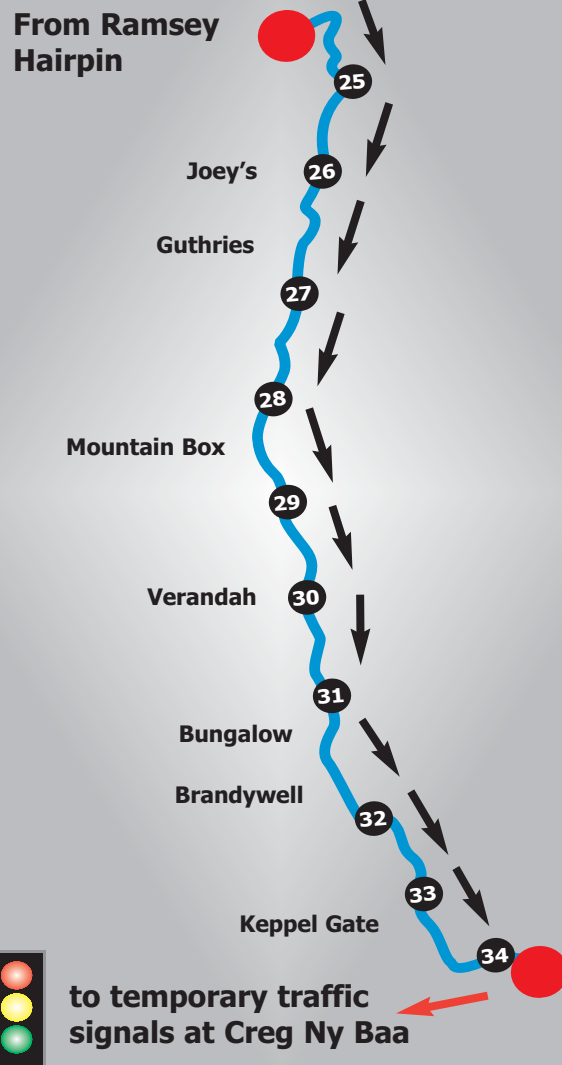

The Mountain Road will close to traffic in both directions from Ramsey Hairpin to Creg Ny Baa at 10.00am on Saturday 28th May to allow for the placement of cones and signs.

It will then reopen later the same day as a one-way road in the direction of the course from Ramsey Hairpin to Creg Ny Baa.

The one way system will be in operation until Monday 13th June

**Published by the Department of Infrastructure.**

Details in this leaflet are correct going to print 18th May but are subject to change.

# TT 2011 Road Safety Information



The Mountain Road will close to traffic in both directions from Ramsey Hairpin to Creg Ny Baa at 10.00am on Saturday 28th May to allow for the placement of cones and signs. It will then reopen later the same day as a one-way road in the direction of the course from Ramsey Hairpin to Creg Ny Baa. Although it will be one-way, it will still be illegal to cross solid white lines. There will be vehicles joining the Mountain Road at the Bungalow and other junctions and the road will be fully policed

during the TT period. Cones will be placed to help guide traffic through various points.

The Mountain Road will close to traffic in both directions from Ramsey Hairpin to Creg Ny Baa at 10.00am on Monday 13th June to allow for the removal of cones and signs. It will then reopen later the same day as a two-way road.

# TT Course

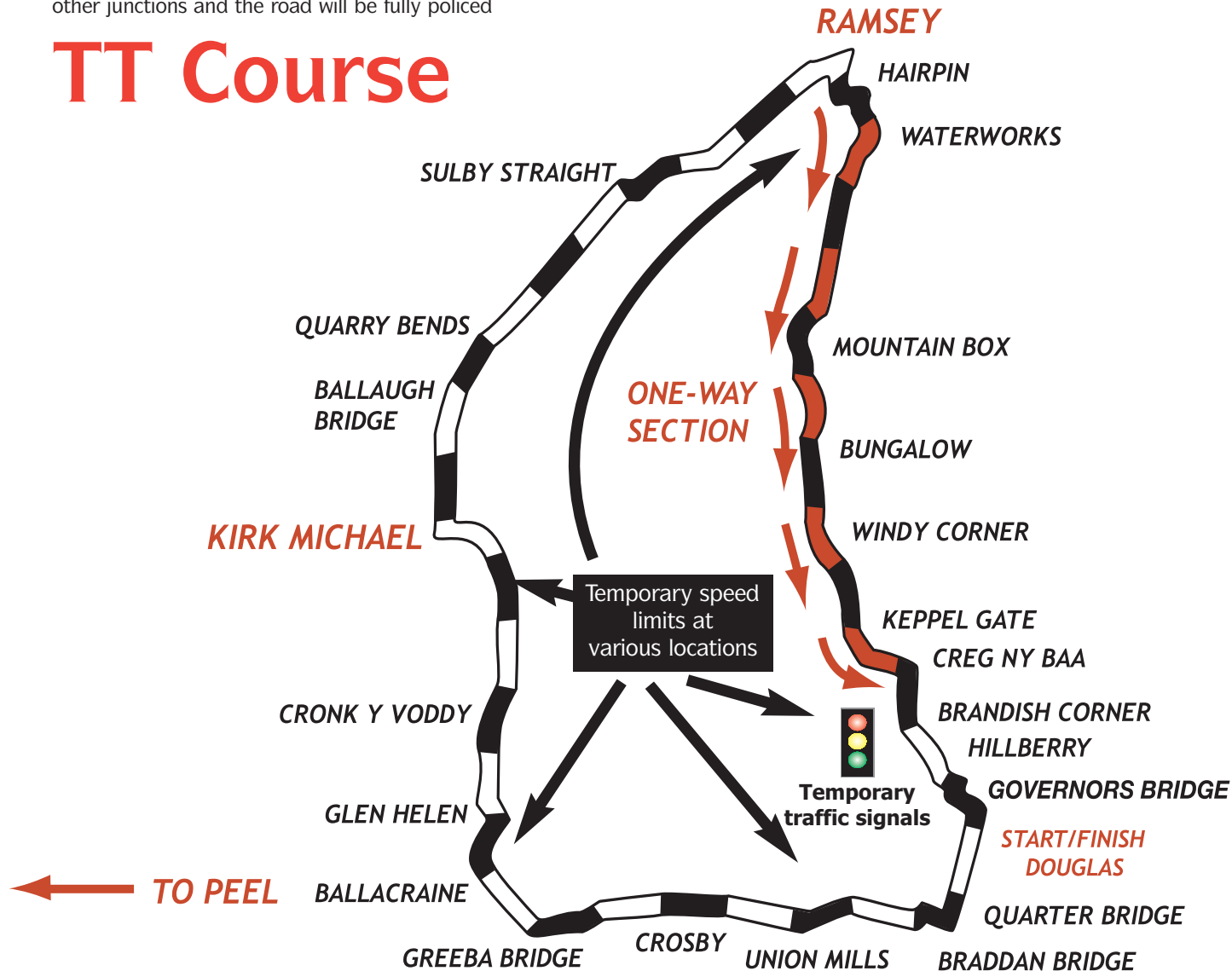

Before you leave the Island take a little time to carefully pack your motorcycle so you have a safe ride home.

The Road Safety Unit promotions vehicle will be touring the Island during the TT festival promoting the 'Meet your mates, not your maker.' campaign at the following locations:

Grandstand	Sat 4th June	Race Day
Peel Promenade	Sun 5th June	Mad Sunday
Mooragh Park, Ramsey	Tues 7th June	Ramsey Sprint
Creg-ny-Baa	Weds 8th June	Race Day
Laxey Promenade	Thurs 9th June	Moddey Dhoo Meeting
Grandstand	Fri 10th June	Senior Race Day
Castletown	Sat 11th June	Post TT Billown Circuit

## SPECTATOR SAFETY AND BEHAVIOUR GUIDELINES

### PROHIBITED AREAS

No persons or vehicle shall, during a closure period, enter or remain on a prohibited area, except to go to the aid of a person or to prevent further danger or risk to the competitors or any other person



The extent of the prohibited area shall be clearly marked and indicated by notices bearing the words "Prohibited Area".

### RESTRICTED AREAS

No person or vehicle shall, during a closure period, enter or remain on a restricted area other than race officials, marshals, police in the course of their duty or other persons or vehicles approved by the clerk of the course.



The extent of the restricted area shall be clearly marked and indicated by notices bearing the words "Restricted Area".

For road closures and traffic information about ALL the Island's roads this TT festival,

**call 685888**